

Supply Chambers

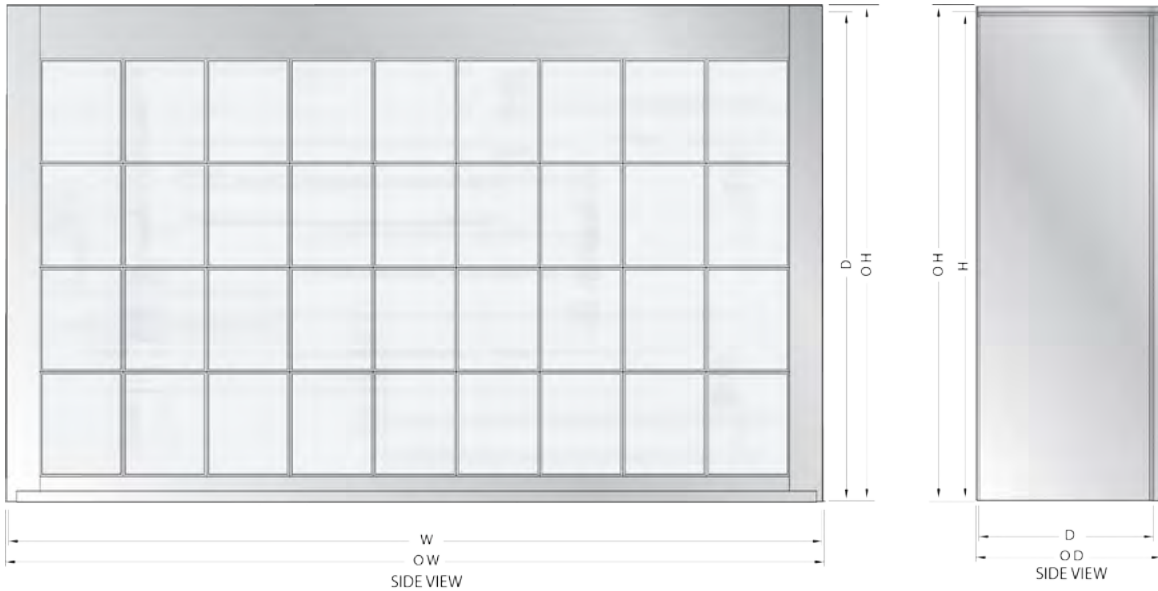

Lower Cost Booth Solution Exhaust/Supply Chambers are ideal for converting an area within your factory for spray painting. They can also be used to create a preparation area for sanding or cleaning parts prior to finishing. We've designed a variety of Exhaust/Supply Chambers that meet your finish requirements while minimizing your floor space. Our Exhaust/Supply Chambers incorporate all of the same design features that are included in our large industrial booths.

Environmentally Safe Each Exhaust/Supply Chamber meets safety and code requirements—NFPA-33, IFC to protect those that work in any industrial spray environment, and the world outside. Your Exhaust/Supply Chamber will be designed to efficiently remove the overspray from the painting operation while maintaining uniform air flow throughout the work area.

Flexible and Adaptable You'll discover that our chambers can be designed for either exhaust/supply or supply. Exhaust/Supply Chambers come with exhaust fan and motor as a package where supply chambers are specifically designed to accommodate an air supply unit – your Spray Systems Advisor can help you design the right chamber for you.

PACKAGE FEATURES & BENEFITS

CNC and CAD Technology—panels are manufactured of premium 18 gauge G-90 galvanized steel, and are precision-punched on six inch centers, allowing for easy nut and bolt assembly, and exploded view assembly drawings supplied

High Efficiency Motor—tri voltage, TEFC, motors that match the high efficiency performance of the exhaust fan
Exhaust Filters—20" x 25" filters yield a larger filter area with a manometer to properly manage timing of filter change-out

Quiet Exhaust Fan—typically operates at low dBA noise levels below OSHA limits

Essential Accessories—all necessary caulking, nuts and bolts, hardware for proper booth installation

Customize Your Spray Room With These Options/Accessories

- Air Make-up Units – help to better heat and pressurize your spray room
- Air Solenoid Valves – helps interlock compressed air system with exhaust fan to meet NFPA-33 codes
- Control Panels – effectively control chamber's exhaust fan, interlocks and lighting
- Exhaust Stack Components – wide variety of exhaust duct components to meet your needs
- Front Filter Doors – can be added to your room to supply filtered air for the exhaust chamber
- Magnahelic Gauges – upgrade of manometer for precise monitoring of your filters
- Safety Shut-Down System – when filters are dirty, system shuts down to protect workers
- Specialized Lighting – help meet tough code requirements and brighten work area
- Specialized Filters – 2 and 3-stage filter systems for special applications

8' High Industrial Supply Chambers

Model Number	Work Dimensions			Overall Dimensions			Rated Airflow SCFM	Supply Filter (Qty)	Shipping Weight Lbs
	W	H	D	OW	OH	OD			
SC-58	5'-0"	7'-9"	2'-6"	5'-4"	8'-1"	2'-8½"	4000	9	360
SC-88	7'-6"	7'-9"	2'-6"	7'-10"	8'-1"	2'-8½"	6400	12	500
SC-108	9'-6"	7'-9"	2'-6"	9'-10"	8'-1"	2'-8½"	8000	15	570
SC-128	12'-0"	7'-9"	3'-0"	12'-4"	8'-1"	3'-2½"	9600	21	690
SC-148	14'-0"	7'-9"	3'-0"	14'-4"	8'-1"	3'-2½"	11200	24	790
SC-168	16'-0"	7'-9"	3'-0"	6'-4"	8'-1"	3'-2½"	12800	27	865
SC-188	18'-0"	7'-9"	3'-6"	18'-4"	8'-1"	3'-8½"	14400	30	995
SC-208	20'-0"	7'-9"	3'-6"	20'-4"	8'-1"	3'-8½"	16000	33	1065
SC-228	22'-0"	7'-9"	3'-6"	22'-4"	8'-1"	3'-8½"	17600	39	1140
SC-248	24'-0"	7'-9"	3'-6"	24'-4"	8'-1"	3'-8½"	19200	42	1245

10' High Industrial Supply Chambers

Model Number	Work Dimensions			Overall Dimensions			Rated Airflow SCFM	Supply Filter (Qty)	Shipping Weight Lbs
	W	H	D	O W	O H	O D			
SC-810	7'-6"	9'-9"	2'-6"	7'-10"	9'-11"	2'-8½"	8000	16	590
SC-1010	9'-6"	9'-9"	3'-0"	9'-10"	9'-11"	3'-2½"	10000	20	700
SC-1210	12'-0"	9'-9"	3'-0"	12'-4"	9'-11"	3'-2½"	12000	28	785
SC-1410	14'-0"	9'-9"	3'-6"	14'-4"	9'-11"	3'-8½"	14000	32	960
SC-1610	16'-0"	9'-9"	3'-6"	16'-4"	9'-11"	3'-8½"	16000	36	1060
SC-1810	18'-0"	9'-9"	3'-6"	18'-4"	9'-11"	3'-8½"	18000	40	1160
SC-2010	20'-0"	9'-9"	3'-6"	20'-4"	9'-11"	3'-8½"	20000	44	1275
SC-2210	22'-0"	9'-9"	3'-6"	22'-4"	9'-11"	3'-8½"	22000	52	1380
SC-2410	24'-0"	9'-9"	3'-6"	24'-4"	9'-11"	3'-8½"	24000	56	1490

12' High Industrial Supply Chambers

Model Number	Work Dimensions			Overall Dimensions			Rated Airflow SCFM	Supply Filter (Qty)	Shipping Weight Lbs
	W	H	D	O W	O H	O D			
SC-812	7'-6"	11'-9"	3'-0"	7'-10"	12'-1"	3'-4½"	9600	20	585
SC-1012	9'-6"	11'-9"	3'-0"	9'-10"	12'-1"	3'-4½"	12000	25	830
SC-1212	12'-0"	11'-9"	3'-6"	12'-4"	12'-1"	3'-10½"	14400	35	1015
SC-1412	14'-0"	11'-9"	3'-6"	14'-4"	12'-1"	3'-10½"	16800	40	1185
SC-1612	16'-0"	11'-9"	3'-6"	16'-4"	12'-1"	3'-10½"	19200	45	1220
SC-1812	18'-0"	11'-9"	3'-6"	18'-4"	12'-1"	3'-10½"	21600	50	1345
SC-2012	20'-0"	11'-9"	3'-6"	20'-4"	12'-1"	3'-10½"	24000	55	1470
SC-2212	22'-0"	11'-9"	3'-6"	22'-4"	12'-1"	3'-10½"	26400	65	1589
SC-2412	24'-0"	11'-9"	3'-6"	24'-4"	12'-1"	3'-10½"	28800	70	1710

Bridge Type Supply Chambers

(To be used in conjunction with spray paint booths)

Model Number	Work Dimensions			Overall Dimensions			Rated Airflow SCFM	Supply Filter (Qty)	Shipping Weight Lbs
	W	H	D	O W	O H	O D			
SCABT	14'-0"	9'-10"	3'-6"	14'-4"	10'-2"	3'-8½"	12600	22	1090
SCATBT	14'-0"	12'-0"	3'-6"	14'-4"	13'-2"	3'-8½"	17000	30	1399
SCTBT	16'-0"	16'-6"	3'-6"	16'-0"	17'-8"	3'-8½"	25600	36	1595

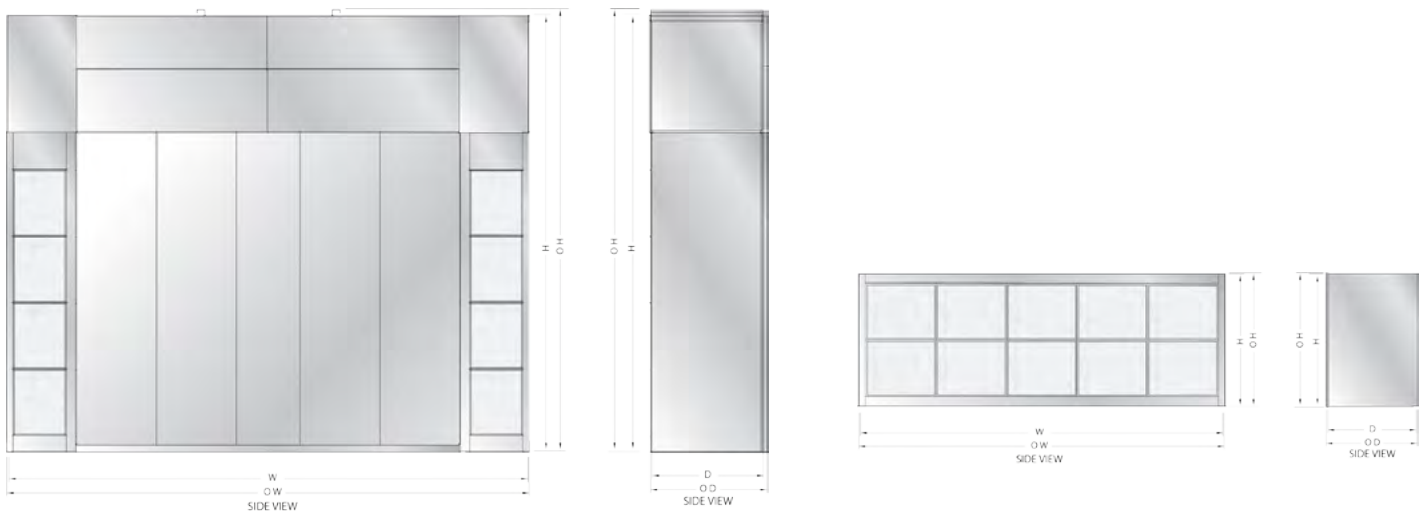

Specifications are subject to change without notice

SUPPLY CABINETS

Model Number	Work Dimensions			Overall Dimensions			Rated Airflow SCFM	Supply Filter (Qty)	Shipping Weight Lbs
	W	H	D	O W	O H	O D			
SC-10	10'-6"	3'-9"	2'-6"	10'-10"	4'-1"	2'-8"	5800	10	390
SC-15	15'-0"	3'-9"	3'-0"	15'-4"	4'-1"	3'-2"	11720	14	423
SC-20	20'-0"	3'-9"	3'-0"	20'-4"	4'-1"	3'-2"	14600	18	624